

EXIT ROUTE FOR CRUISE COACHES FROM
CRUISE AREA TO DUBLIN CITY CENTRE

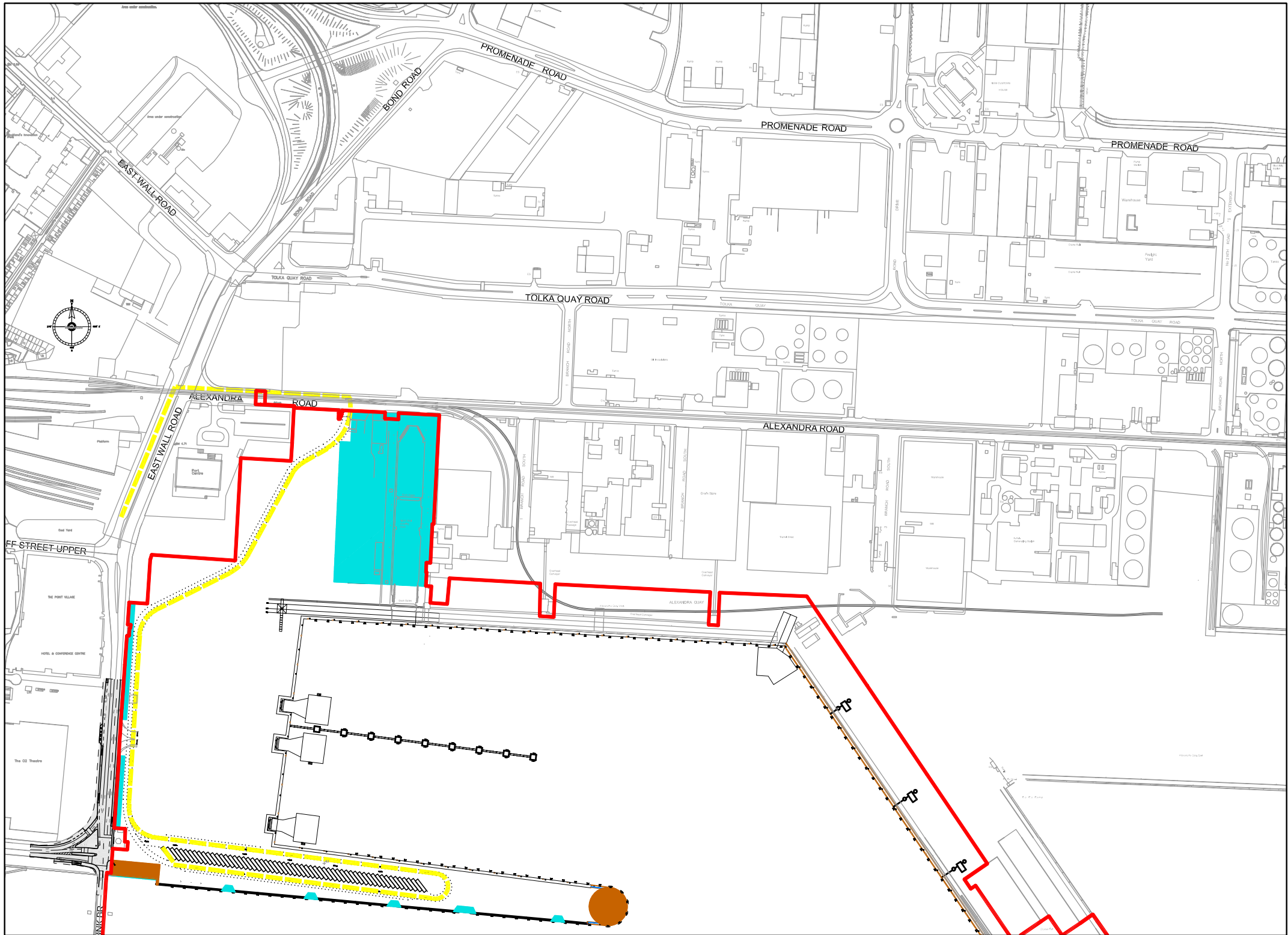

ENTRY ROUTE FOR CRUISE COACHES FROM
DUBLIN CITY CENTRE TO CRUISE AREA

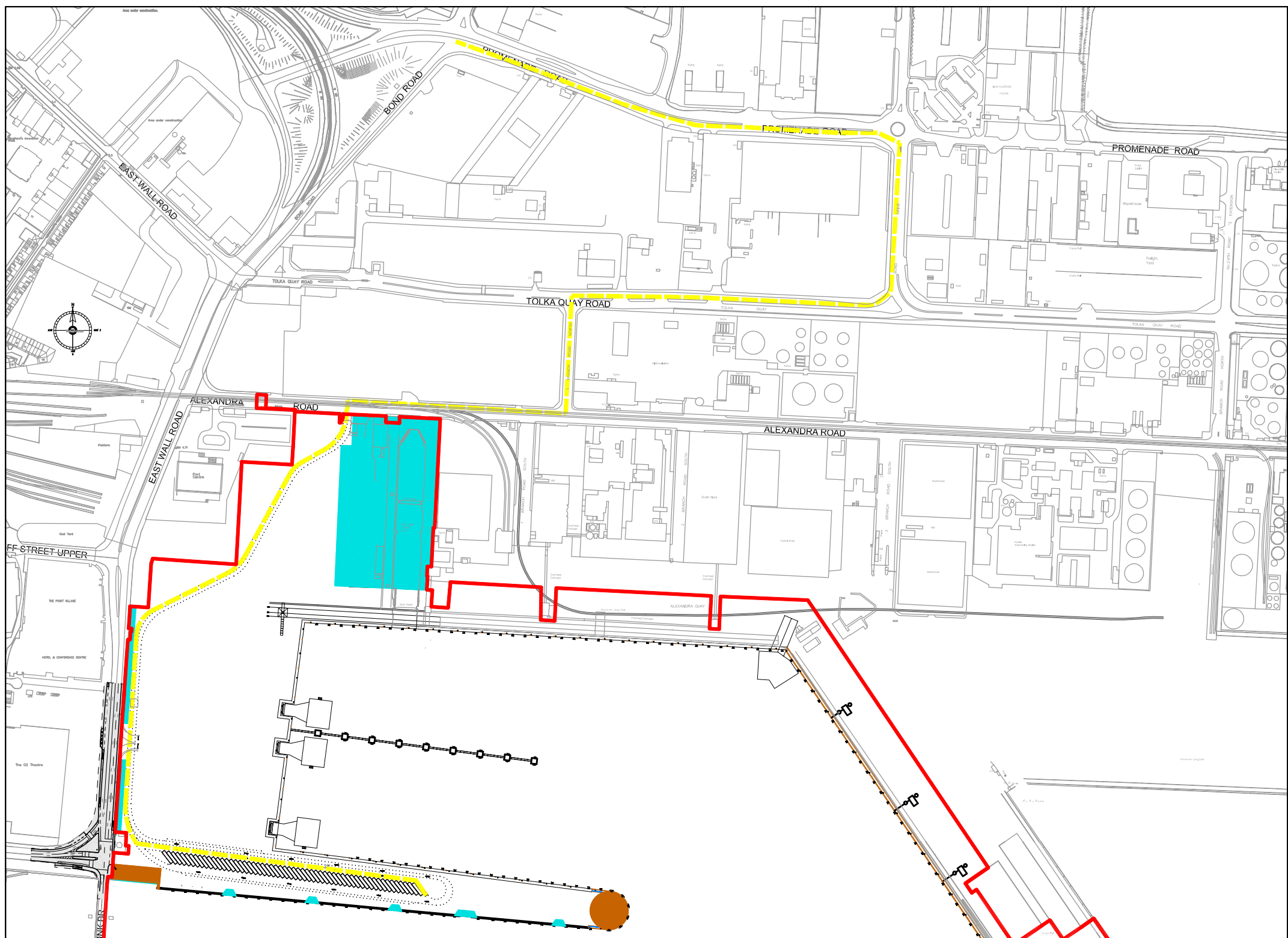

EXIT ROUTE FOR CRUISE COACHES FROM
CRUISE AREA TO NORTHBOUND/TUNNEL

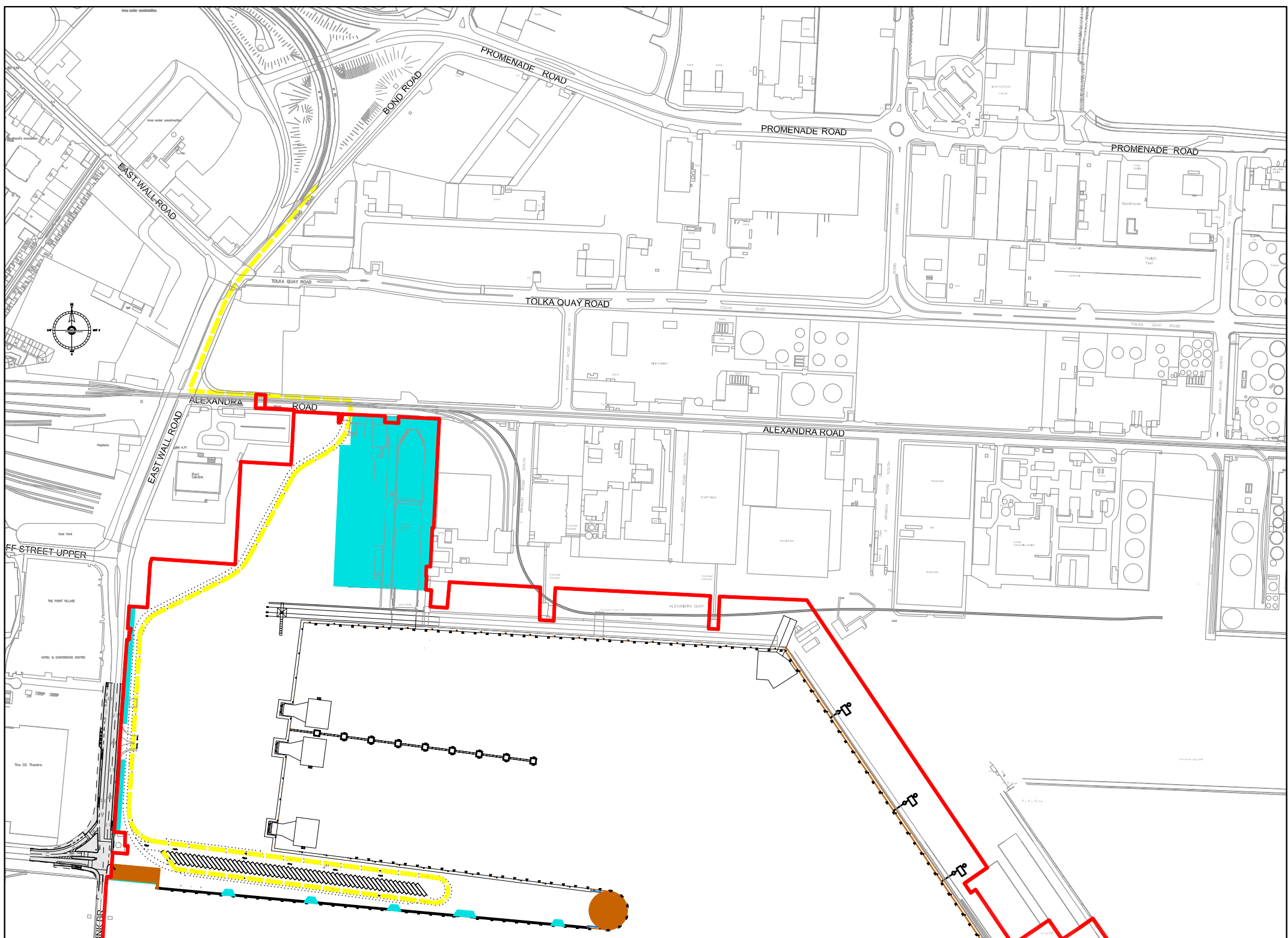

ENTRY ROUTE FOR CRUISE COACHES FROM
NORTH/TUNNEL TO CRUISE AREA

100m SCALE 1:5000

NOTES

- Verifying Dimensions.
The contractor shall verify dimensions against such other drawings or site conditions as pertain to this part of the work.
- Existing Services.
Any information concerning the location of existing services indicated on this drawing is intended for general guidance only. It shall be the responsibility of the contractor to determine and verify the exact horizontal and vertical alignment of all cables, pipes, etc. (both underground and overhead) before work commences.
- Issue of Drawings.
Hard copies, dwf and pdf will form a controlled issue of the drawing. All other formats (dwg, dxf etc.) are deemed to be an uncontrolled issue and any work carried out based on these files is at the recipient's own risk. RPS will not accept any responsibility for any errors arising from the use of these files, either by human error by the recipient, listing of un-dimensioned measurements, compatibility issues with the recipient's software, and any errors arising when these files are used to aid the recipient's drawing production, or setting out on site.
- DATUM: Ordnance Datum Malin (Unless Noted Otherwise)

INDICATION OF SECTION OF DCCNTA
HIGHWAY IMPROVEMENT SCHEME

CONSERVATION ZONE
(REFER TO MOLA DRAWINGS FOR DETAILS)

INTERPRETATIVE ZONE
(REFER TO MOLA DRAWINGS FOR DETAILS)

PLANNING BOUNDARY
UNDER THIS APPLICATION

TOTAL
BOUNDARY AREA: 5348426 m²
(534.843ha)

PROPOSED MARSHALLING DELINEATION
FOR CRUISE TRAFFIC

rev	amendments	drawn	date
-----	------------	-------	------

RPS Elmwood House
74 Boucher Road
Belfast
BT12 6RZ

T +44 (0) 28 90 667914
F +44 (0) 28 90 668286
W www.rpsgroup.com/ireland
E ireland@rpsgroup.com

Client

COMHLAcht CHALAFORT
ÁTHA CLIATH
DUBLIN PORT COMPANY

Project

Alexandra Basin Redevelopment

Title

Proposed Routing for Cruise
Vehicular Traffic - Sheet 1 of 2

Architect

-

Drawing Status	Sheet Size	Drawing Scale
Planning	A1	1:5000

Drawing Number	Rev
IBH0362-RF12-03	-

Project Leader	Drawn By	Date	Initial Review
BD	TN	MAR 2015	CD