

EXISTING PORT GATES TO BE RETAINED AND RESTORED AS APPROPRIATE FOLLOWING INSPECTION AND SURVEY REFER TO SOUTHGATE ASSOCIATES REPORT FOR DETAILS OF APPROPRIATE WORKS TECHNIQUES AND FINISHES

LVL +09.840(ODM)+12.350(CD)

INDICATIVE OF DCC CABLE TUNNEL ACCESS POINT

INDICATIVE OF VMU FACILITY TO BE DEMOLISHED AS PART OF WORKS REFER TO RPS DEMOLITION DRAWINGS FOR FURTHER DETAILS

INDICATIVE OF RO-RO FREIGHT TERMINAL TO BE DEMOLISHED AS PART OF WORKS REFER TO RPS DEMOLITION DRAWINGS FOR FURTHER DETAILS

Existing Quay Wall LVL +03.450(ODM)+05.960(CD)

(HAT) LVL +01.990 (ODM)+04.500 (CD)

ODM (Malin Head) +00.000 (ODM)+02.510 (CD)

4800

2510

1m

1:100 at A1

(LAT) LVL -2.610(ODM)-00.100(CD)

OD Chart Datum -02.510 (ODM/ 00.000(CD))

01 EXISTING SECTION BB (IP-1)
2311 Scale 1:100

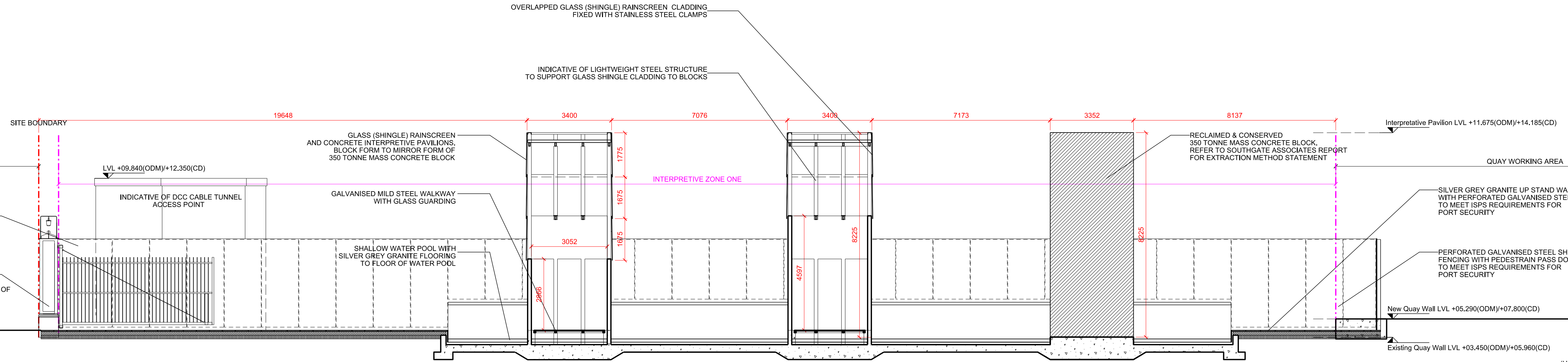

(HAT) LVL +01.990 (ODM)+04.500 (CD)

ODM (Malin Head) +00.000 (ODM)+02.510 (CD)

4800

2510

1m

1:100 at A1

(LAT) LVL -2.610(ODM)-00.100(CD)

OD Chart Datum -02.510 (ODM/ 00.000(CD))

02 PROPOSED SECTION BB (IP-1)
2311 Scale 1:100

NOTES / LEGEND

REFER TO SOUTHGATE ASSOCIATES REPORT FOR DETAILS OF CONSERVATION STRATEGY

REFER TO RPS IRELAND DRAWINGS AND DOCUMENTATION FOR DETAILS OF OVERALL WORKS AS PART OF THE ABR PROJECT

- CONSERVATION ZONE
- INTERPRETATIVE ZONE
- CONSERVATION WORKS TO BE UNDERTAKEN
- DEMOLITION WORKS TO BE UNDERTAKEN
- RE-LOCATION WORKS TO BE UNDERTAKEN

ALL DATUM RELATIVE TO ORDNANCE DATUM MALIN UNLESS NOTED OTHERWISE
-02.510 (ODM)=(CD)
REFER TO CHART DATUM (DUBLIN PORT)
ORDNANCE DATUM (ODM)
2.51M
CHART DATUM (C.D.)
HIGHEST ASTRONOMICAL TIDE (HAT)
LOWEST ASTRONOMICAL TIDE (LAT)

Revision	Date	Description	By
PP	05.03.14	Planning Application	MOLA

Drawing Status: **PLANNING**

Reply Address: Fumbally Square, Telephone +353 1 453 7300, Dublin 08, Ireland, www.molaarchitecture.com

Note: Do not scale. Use figured dimensions only. This drawing is to be read in conjunction with all relevant specifications and drawings. All dimensions to be checked on site. In the event of any discrepancies between drawings the contractor is to inform the Architect immediately.

COMHLACHT CHALAFORT ATHA CLIATH DUBLIN PORT COMPANY

SOUTHGATE ASSOCIATES

CONSERVATION ENGINEERING AND DESIGN
PLANNING AND DEVELOPMENT STRATEGIES

RESTORATION AND CONSERVATION
HERITAGE APPRAISAL AND ASSESSMENT

mōla architecture

ARCHITECTS PLANNERS URBAN DESIGNERS

Client: DUBLIN PORT COMPANY LTD.
Project: ALEXANDRA BASIN RE-DEVELOPMENT (ENTRANCE GATES)
Date: MAR 14 Scale: 1/100 @ A1 Drawn by: MOLA
Job No.: 130111 Stage: 02 Dwg No.: 2311 Rev.: PP